

Rhif y Cais / Application Number : C15/0793/32/LL

Cynllun lleoliad ar gyfer adnabod y safle yn unig. Dim i raddfa.  
Location Plan for identification purposes only. Not to scale.

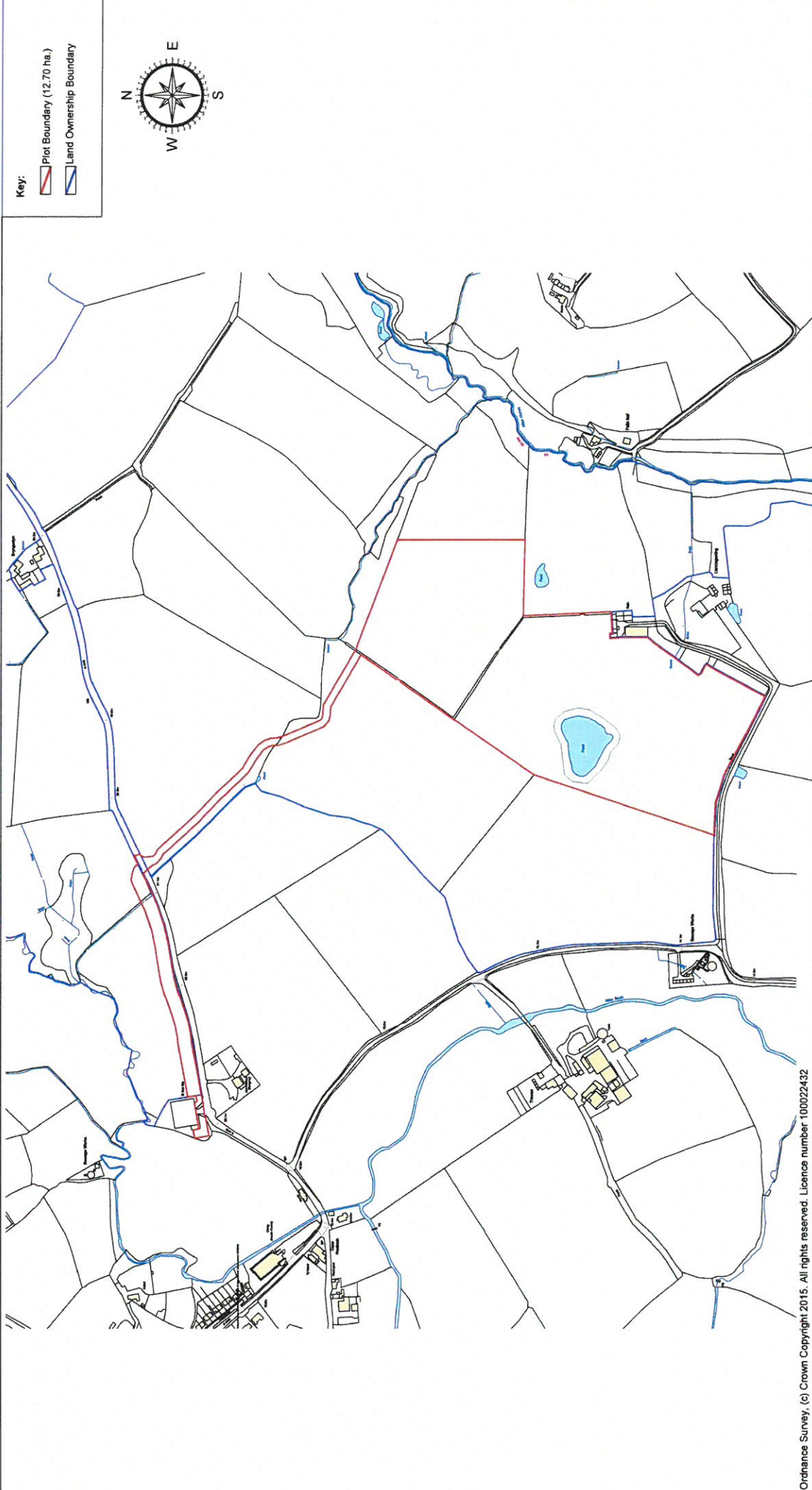





Ordnance Survey, (c) Crown Copyright 2015. All rights reserved. Licence number 100022432

|   |            |  |          |
|---|------------|--|----------|
| <b>Plan description:</b><br>Botwnnog Solar Farm<br>Site Location Plan   |            | <b>Drawing Reference:</b><br>Botwnnog Solar Farm_PO1_SLP_Rev8  |          |
| Date:   | Editor:    | Revision:  | Checked: |
| 20/08/2015  | M.L.C.     |  |          |
| 20/11/2015  | M.L.C.     |  |          |
|   | Date:      | Scale:   |          |
|   | 20/08/2015 | 1:2500@A1  |          |
| <b>Site:</b><br>Botwnnog Solar Farm<br>Land south-east of Botwnnog<br>Pwllheli,<br>Gwynedd<br>LL538DP   |            | Coordinates: longitude: -04.5710 latitude: 52.8460<br>Reference drawings:  |          |
| <b>BELECTRIC®</b><br>Thorney Weir House,<br>Thorney Mill Lane, Iwer,<br>Buckinghamshire, SLO 9AQ<br>Tel: +44 (0) 1895 452 640<br>Web: www.belectric.co.uk |            | Variations in design can occur to site conditions. This drawing may not be reproduced or be made available to third persons or competing companies without permissions. The reproduction, distribution and utilization of this document as well as the communication of its contents without explicit authorization is prohibited. Offenders will be held liable and can be fined. |          |



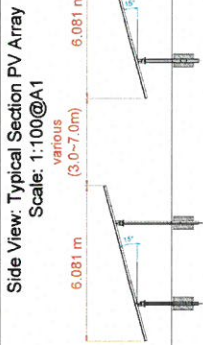

Typical Elevation for Gate  
Scale: 1:50@A1

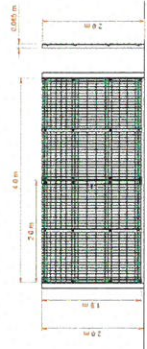

Typical Elevation for Fence  
Scale: 1:50@A1



Cross section of swale  
Scale: 1:10@A1



Typical Elevation for PV Array  
Scale: 1:100@A1

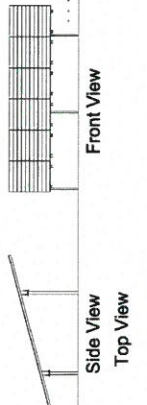

Side View  
Top View

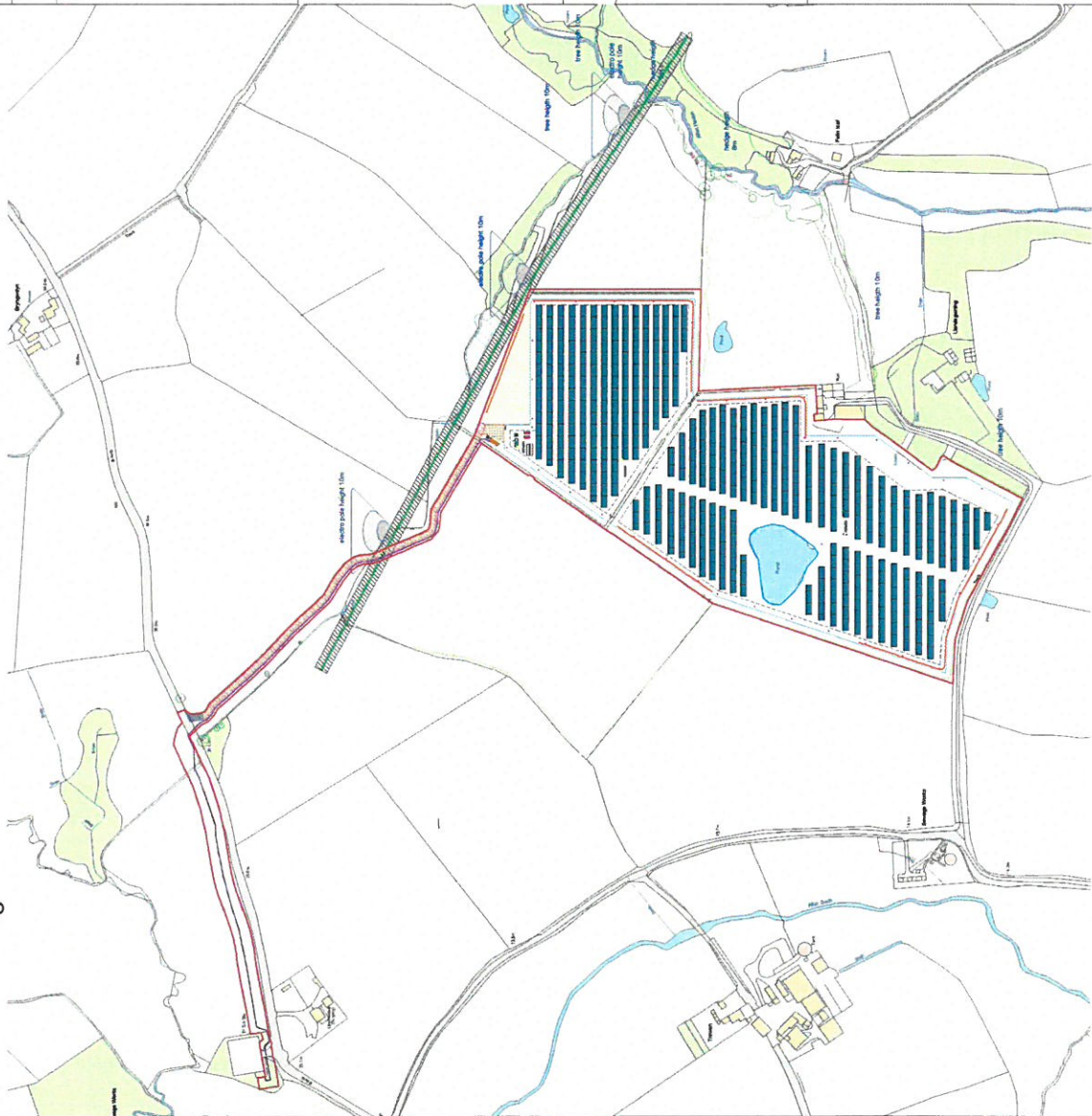
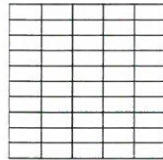

© Driffton Rural (1) Owen Copyright 2015. All rights reserved. Licence number 10002322

# Site Plan

## Botwnnog Solar Farm

Coordinates 52.8460° N 04.5710° W

Country - United Kingdom  
Region / Province - Gwynedd  
Municipality - Botwnnog

### Key

- |                             |   |
|-----------------------------|---|
| Modules Structures          | Temporary Construction Compound           |
| Site Boundary               | Gates                                     |
| Fencing                     | DNO Access and O&M Access                 |
| Construction Boundary       | Track and Hard Standing Area              |
| Temporary Construction      | Temporary Construction Access Road        |
| Double Inverter Station     | Existing Hedge                            |
| Storage Container           | Proposed Cable Route                      |
| Container                   | Electric overhead line                    |
| DNO Transfer Station        | 6.643m CCTV Pole (3no.)                   |
| Collecting Station          | Meter Box (Close to DNO Transfer Station) |
| Auxiliary Transformer       | Swales                                    |
| ComBox, FoBox & Antenna     | Heavy Vehicle Crossing Area               |
| PADCON monitoring camera    | Weather sensors                           |
| Proposed Hedgerow           | Master Nodes (4 no.)                      |
| RDC Ground Sensors (37 no.) |   |

### Project Data

plot area - approx. 12.70 ha  
Area of perimeter fencing - approx. 9.94 ha  
Length of perimeter fencing - approx. 1,540 m  
Inverters - 4 x SMA SC 900 CP XT  
= 2 Double Inverter Stand

### Collecting Stations

- 1

### Plant System Rating (about)

- 4.9995 MWp-DC

### construction and parameter

shading - 1.5 modules  
sun angle / shadow angle - 13.72° / 18.78°

### sketch from the table section

not to scale

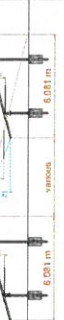

### more parameter

considered  not considered

Shadow  Ground inclination north / south

Ground inclination east / west

V2 Amendments in Red line and cable route M.L.C 20.11.15

V1 Site Plan M.L.C 20.08.15

Rev changes in the design name date checked date

for review  for construction  as built

Site Plan scale 1: 2500 @ A1

Drawing Number Botwnnog Solar Farm\_P02\_SP\_RevB

BELECTRIC GmbH  
Wiederhammer Str. 10  
97509 Kalthausen  
Tel. +49 (0)9345 9844-0  
Fax. +49 (0)9345 9844-990  
BELECTRIC  
Christijan Fries  
COO

This drawing may not be reproduced or be made available to third parties or contractors, companies without the written consent of the author. The reproduction, distribution and utilization of this document as well as the communication of its contents without explicit permission of the author is prohibited. All rights reserved. Variations in design can occur to the conditions.



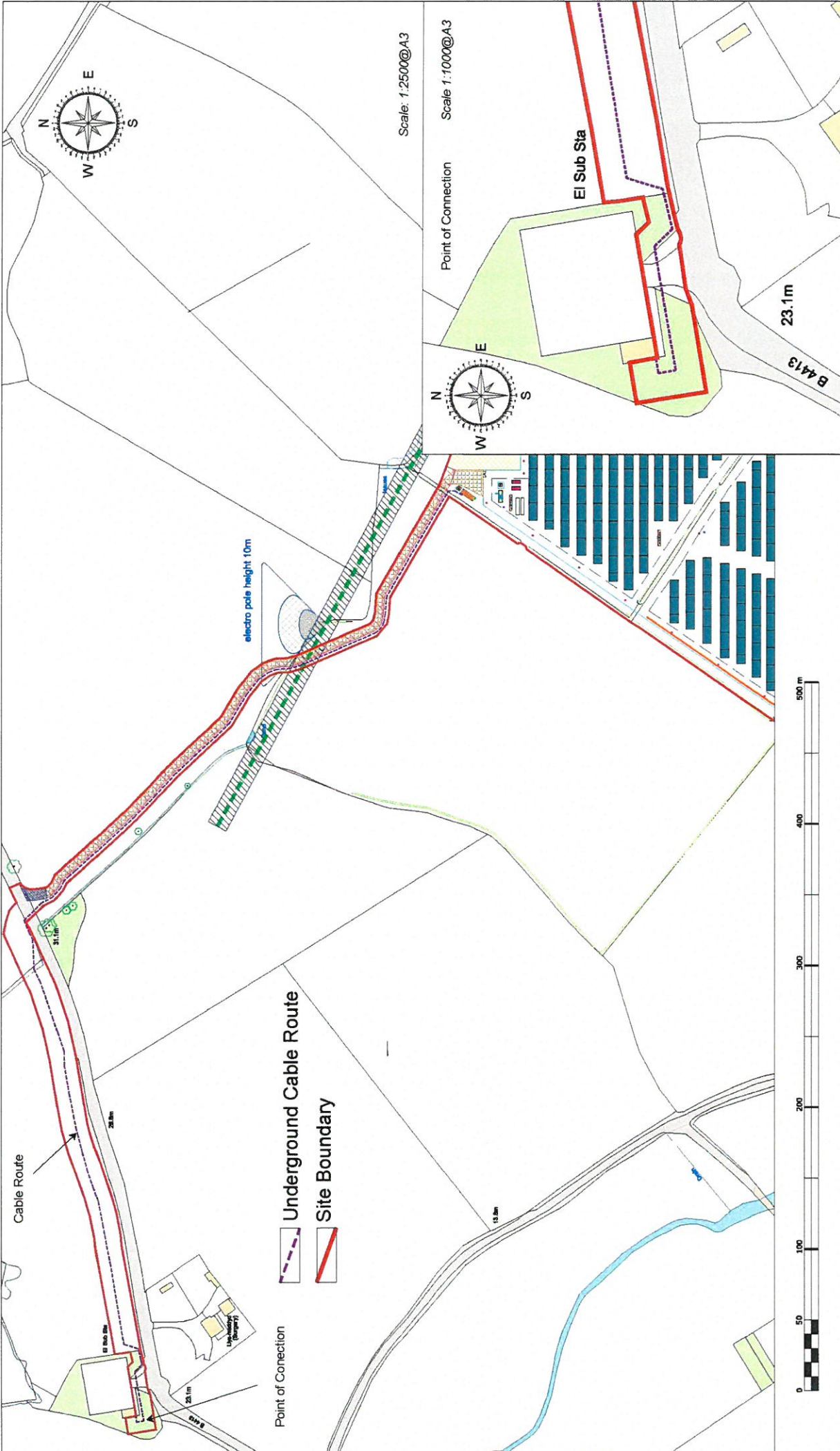

|  |            |  |         |
|--|------------|--|---------|
| <b>Plan description:</b><br>Botwmnog Solar Farm<br>Cable Route, Point of Connection  |            | <b>Drawing Reference:</b><br>Botwmnog Solar Farm_P23_POC_Final   |         |
| Date:  | 21/08/2015 | Editor:  | M.L.C.  |
| Revision:  |            | Checked:   |         |
| Date:  | 20/11/2015 | Scale:   | various |
| <b>Coordinates:</b> longitude: -04 5710 latitude: 52 84 60<br><b>Reference drawings:</b>   |            | <b>Site:</b><br>Botwmnog Solar Farm<br>Land south-east of Botwmnog<br>Pwllheil,<br>Gwynedd<br>LL53 8DP |         |
| <b>BELECTRIC®</b><br>Solar Ltd, United Kingdom<br>Thorney Weir House,<br>Thorney Mill Lane, Iwer,<br>Buckinghamshire, SL0 9AQ<br>Tel: +44 (0) 1895 452 640<br>Web: www.belectric.co.uk |            |  |         |

Variations in design can occur to site conditions. This drawing may not be reproduced or be made available to third persons or competing companies without permissions. The reproduction, distribution and utilization of this document as well as the communication of its contents without explicit authorization is prohibited. Offenders will be held liable and can be fined.

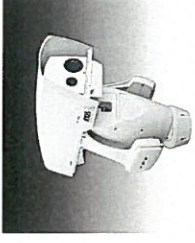

Colour of CCTV Pole and Electrical Box: Moss Green (RAL 6005)



Colour of Camera: White



Not to Scale

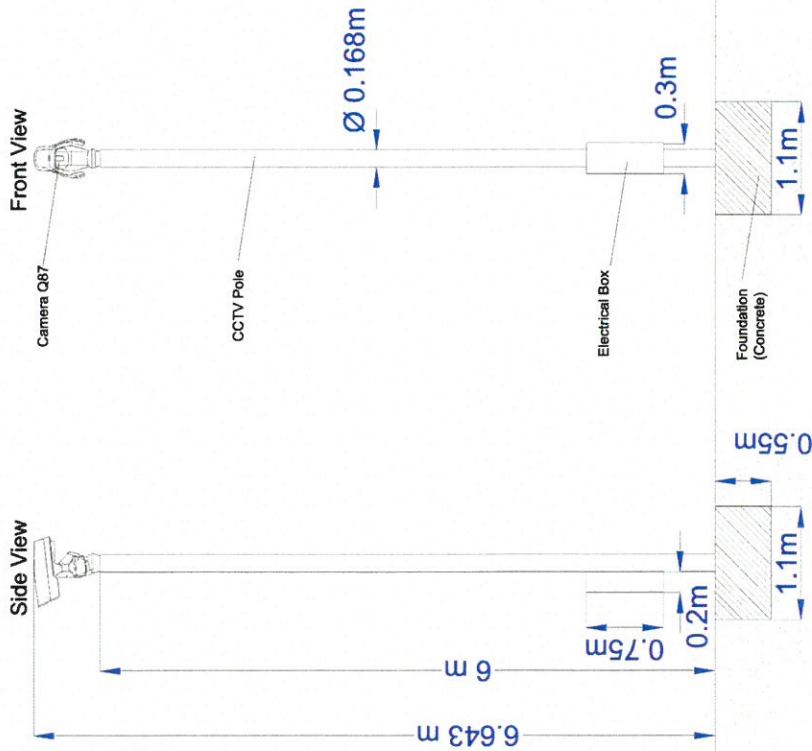

Scale: 1:50@A3

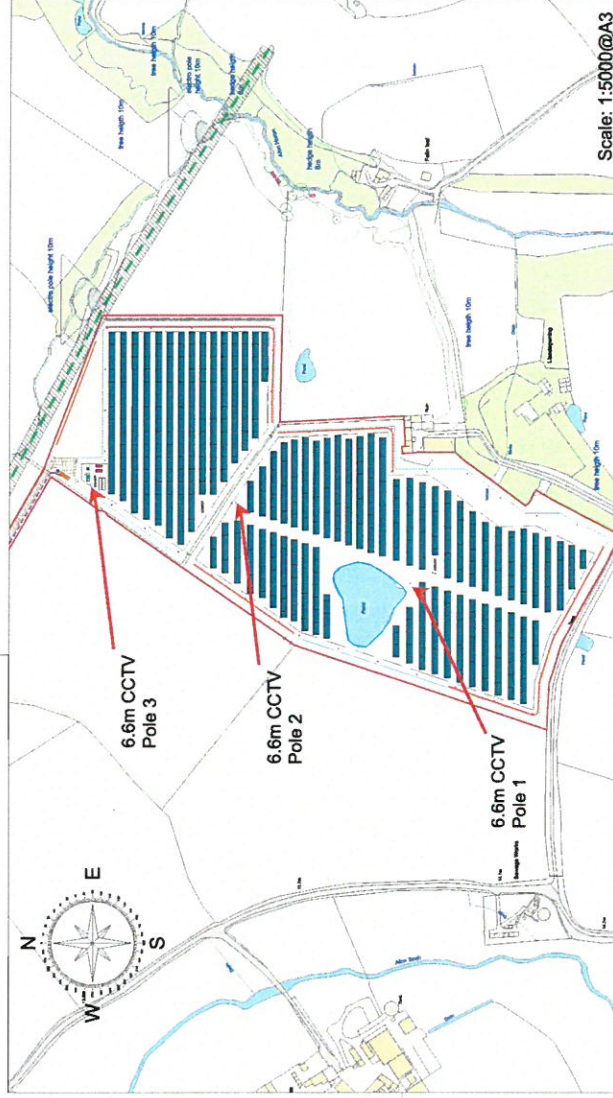

Scale: 1:5000@A3

**BELECTRIC®**  
Solar Ltd, United Kingdom  
Thorney Weir House,  
Thorney Mill Lane, Iwer,  
Buckinghamshire, SL0 9AQ  
Tel: +44 (0) 1895 452 640  
Web: www.belectric.co.uk

Site:  
Botwnnog Solar Farm  
Land south-east of Botwnnog  
Pwllheli,  
Gwynedd  
LL53 8DP

|                     |                     |                   |
|---------------------|---------------------|-------------------|
| Coordinates:        | longitude: -04.5710 | latitude: 52.8460 |
| Reference drawings: |                     |                   |
|                     |                     |                   |
|                     |                     |                   |

|                    |                                     |
|--------------------|-------------------------------------|
| Drawing Reference: | Botwnnog Solar Farm_P22_fmCCTV_RevA |
| Date:              | 21/08/2015                          |
| Editor:            | M.L.C.                              |
| Revision:          |                                     |
| Checked:           |                                     |
| Date:              | 21/08/2015                          |
| Scale:             | Various                             |

Plan description:  
Botwnnog Solar Farm  
Pole-mounted CCTV Proposal

Variations in design can occur to site conditions. This drawing may not be reproduced or be made available to third persons or competing companies without permissions. The reproduction, distribution and utilization of this document as well as the communication of its contents without explicit authorization is prohibited. Offenders will be held liable and can be fined.



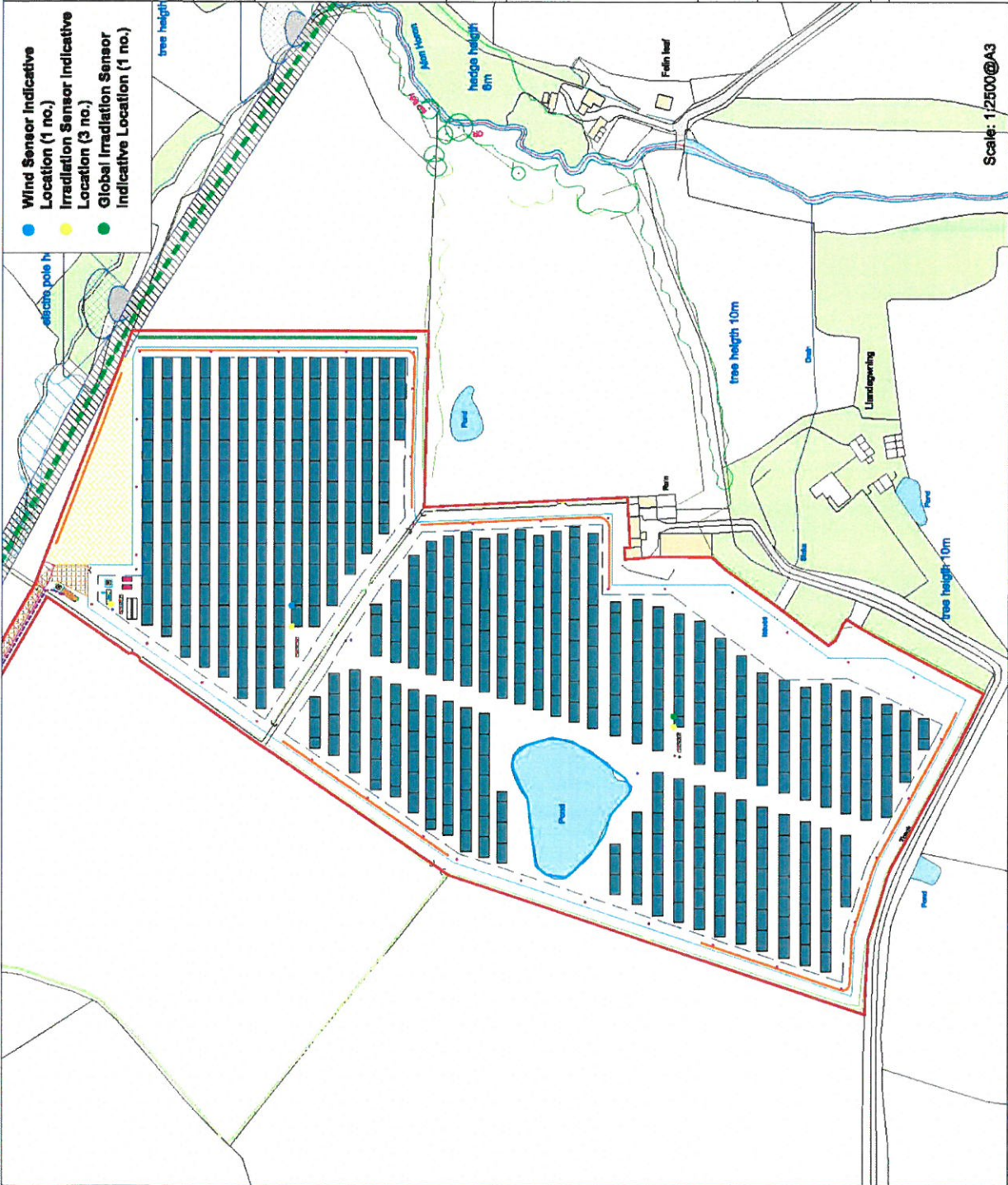
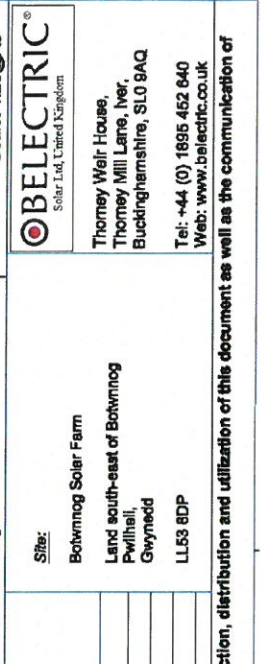
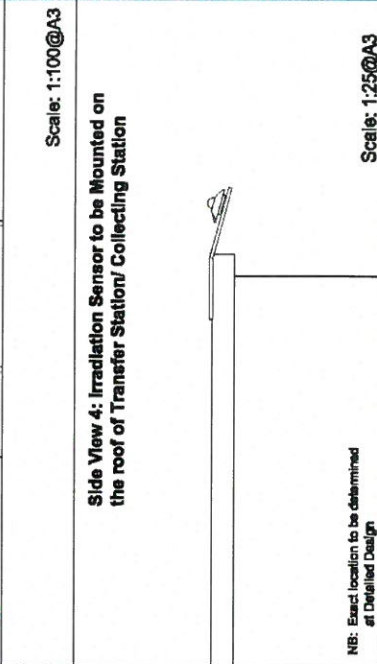
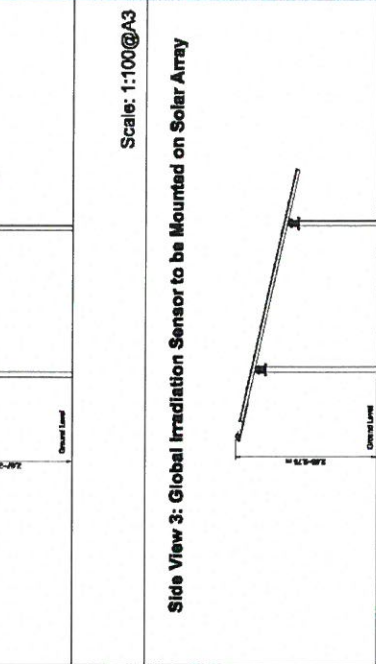
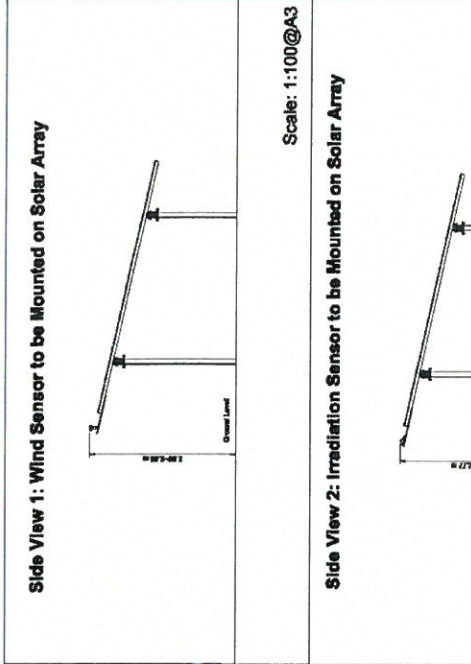

|  |                          |  |                 |
|--|--------------------------|--|-----------------|
| <b>Plan description:</b><br>Botnong Solar Farm<br>Sensors Plan                                       |                          | <b>Drawing Reference:</b><br>Botnong Solar Farm_P17_Sensors_Plan   |                 |
| <b>Date:</b><br>21/08/2015   | <b>Editor:</b><br>M.L.C. | <b>Revision:</b>   | <b>Checked:</b> |
| <b>Date:</b><br>21/08/2015   |                          | <b>Scale:</b><br>various   |                 |
| <b>Coordinates:</b><br>longitude: -04.5710 latitude: 52.9480   |                          | <b>Reference drawings:</b>   |                 |
| <b>Site:</b><br>Botnong Solar Farm<br>Land south-east of Botnong<br>Pwllheli,<br>Gwynedd<br>LL53 8DP |                          | <b>BELECTRIC®</b><br>Solar Ltd, United Kingdom<br>Thorney Well House,<br>Thorney Mill Lane, Iwer,<br>Buckinghamshire, SL0 9AQ<br>Tel: +44 (0) 1895 452 840<br>Web: www.belectric.co.uk |                 |

Variances in design can occur to site conditions. This drawing may not be reproduced or be made available to third persons or competing companies without permissions. The reproduction, distribution and utilization of this document as well as the communication of its contents without explicit authorization is prohibited. Offenders will be held liable and can be fined.



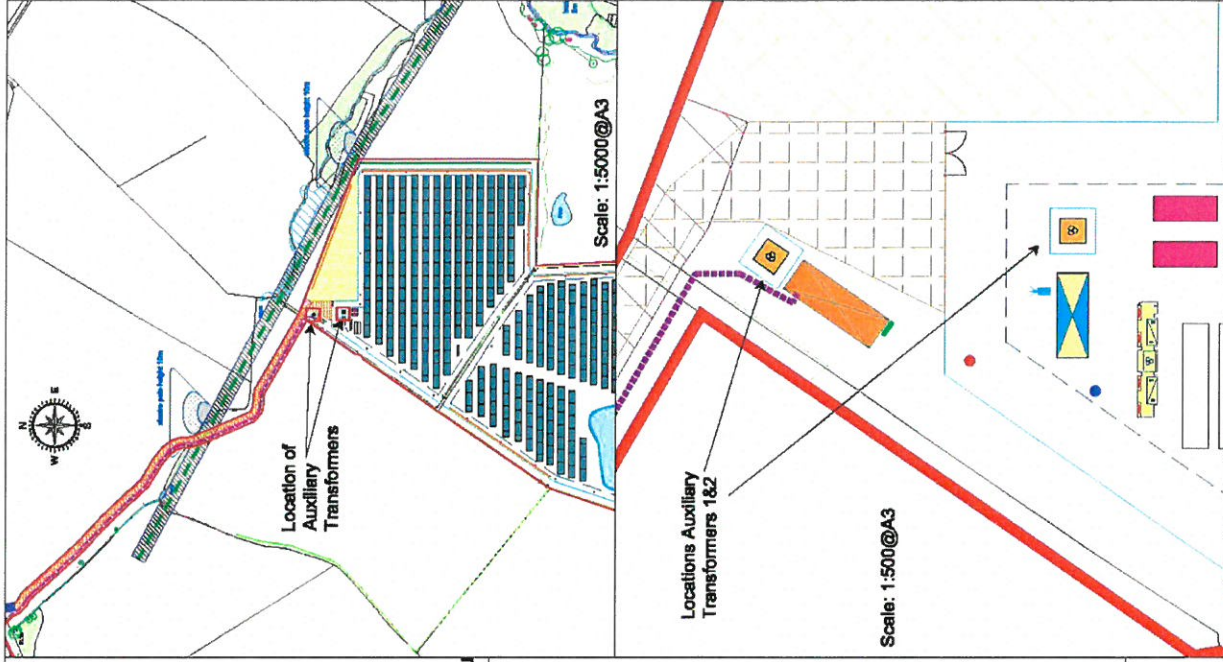
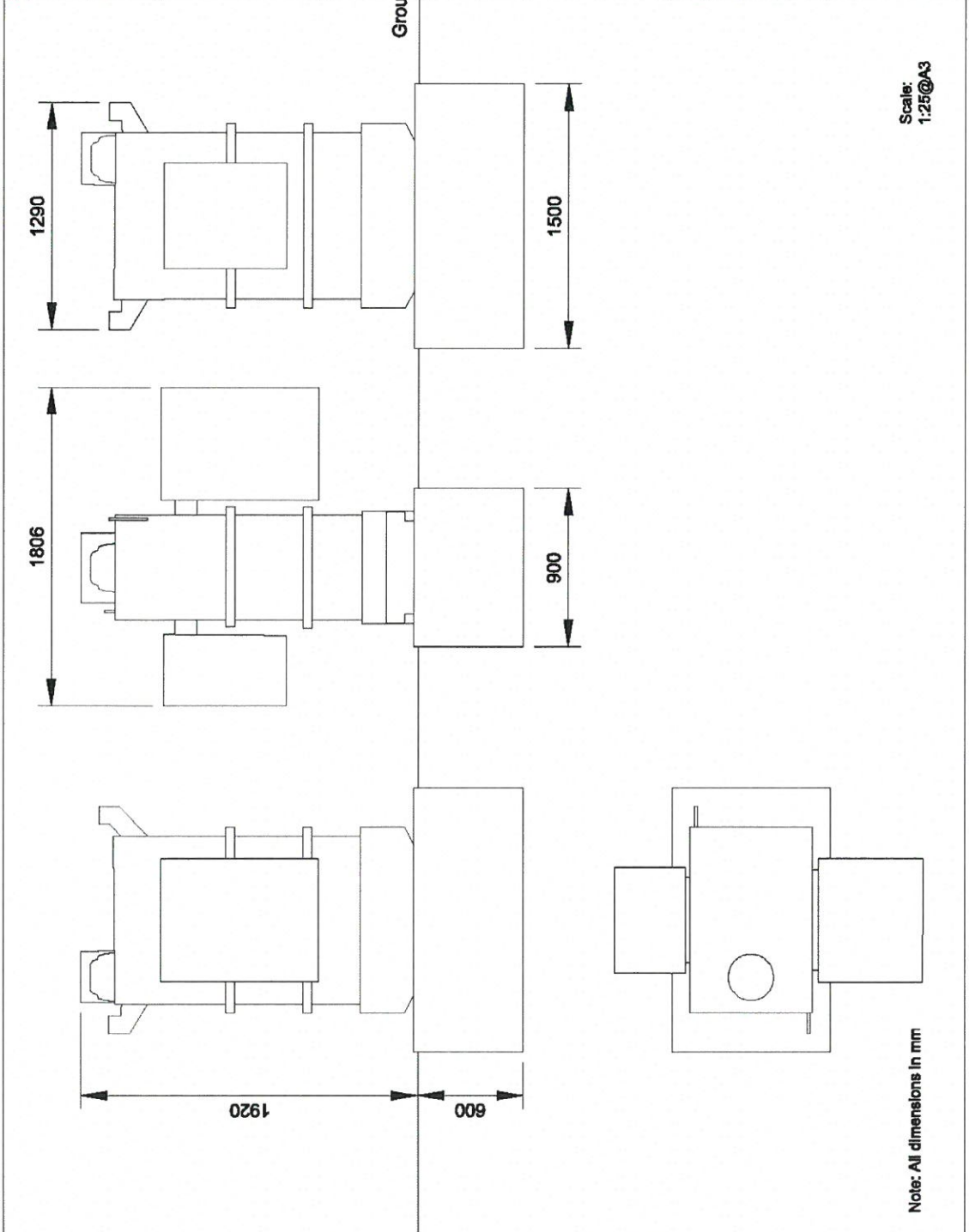

|  |                          |  |                 |
|--|--------------------------|--|-----------------|
| <b>Plan description:</b><br>Botwnnog Solar Farm<br>Auxiliary Transformer                               |                          | <b>Drawing Reference:</b><br>Botwnnog Solar Farm_P18_AT_RevA   |                 |
| <b>Date:</b><br>21/08/2015   | <b>Editor:</b><br>M.L.C. | <b>Revision:</b>   | <b>Checked:</b> |
| <b>Coordinates:</b> longitude: -04.5710 latitude: 52.8480  |                          | <b>Reference drawings:</b>   |                 |
| <b>Date:</b><br>21/08/2015   |                          | <b>Scale:</b><br>various   |                 |
| <b>Site:</b><br>Botwnnog Solar Farm<br>Land south-east of Botwnnog<br>Pwllheli,<br>Gwynedd<br>LL53 8DP |                          | <b>OBLECTRIC®</b><br>Solar Ltd, United Kingdom<br>Thorney Weir House,<br>Thorney Mill Lane, Iwer,<br>Buckinghamshire, SLO 9AQ<br>Tel: +44 (0) 1895 452 640<br>Web: www.oblectric.co.uk |                 |

Varitions in design can occur to site conditions. This drawing may not be reproduced or be made available to third persons or competing companies without permissions. The reproduction, distribution and utilization of this document as well as the communication of its contents without explicit authorization is prohibited. Offenders will be held liable and can be fined.

# Front View

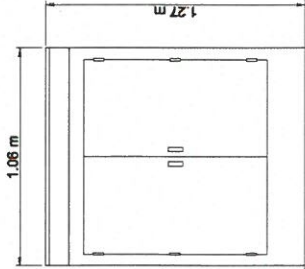

# Side View

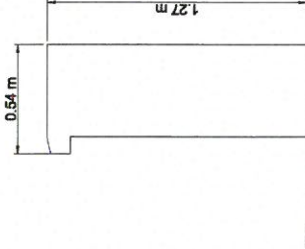

# Top View

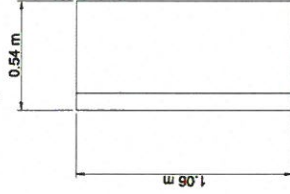

Colour:  
Dark Green

Scale: 1:25@A3

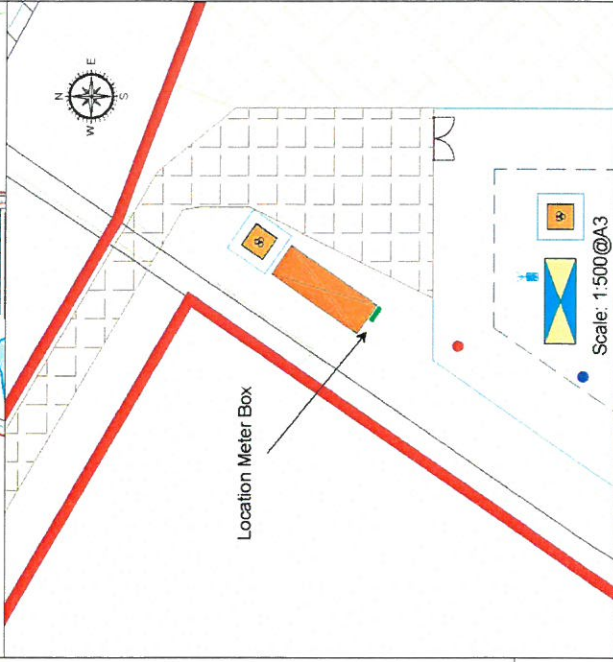
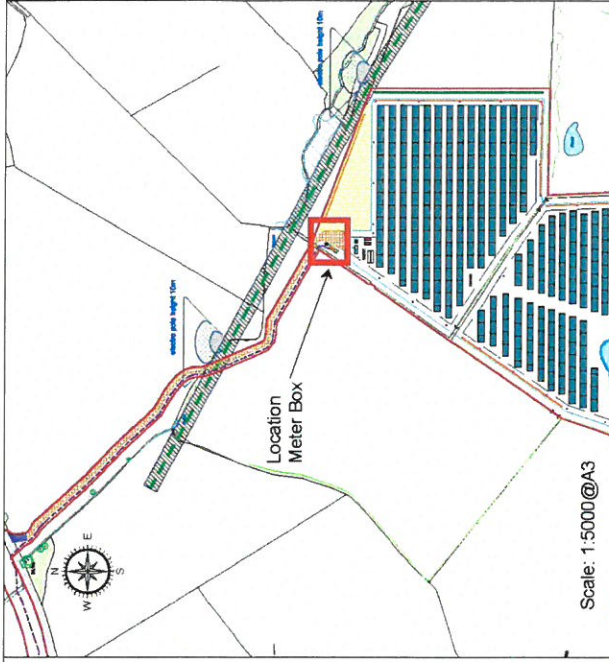

|  |                          |  |                          |
|--|--------------------------|--|--------------------------|
| <b>Plan description:</b><br>Botwnnog Solar Farm<br>Meter Box Elevations                                |                          | <b>Drawing Reference:</b><br>Botwnnog Solar Farm_P15_MB_RevB   |                          |
| <b>Date:</b><br>21/08/2015   | <b>Editor:</b><br>M.L.C. | <b>Revision:</b>   | <b>Checked:</b>          |
| 20/11/2015   | M.L.C.                   | <b>Date:</b><br>20/11/2015   | <b>Scale:</b><br>various |
| <b>Coordinates:</b><br>longitude: -04.5770    latitude: 52.8460  |                          | <b>Reference drawings:</b>   |                          |
| <b>Site:</b><br>Botwnnog Solar Farm<br>Land south-east of Botwnnog<br>Pwllheli,<br>Gwynedd<br>LL53 8DP |                          | <b>OBLECTRIC®</b><br>Solar Ltd, United Kingdom<br>Thorney Weir House,<br>Thorney Mill Lane, Iwer,<br>Buckinghamshire, SL0 9AQ<br>Tel: +44 (0) 1895 452 640<br>Web: www.belectric.co.uk |                          |

Variations in design can occur to site conditions. This drawing may not be reproduced or be made available to third persons or competing companies without permissions. The reproduction, distribution and utilization of this document as well as the communication of its contents without explicit authorization is prohibited. Offenders will be held liable and can be fined.







Camera side & top view  
(measurements in mm)

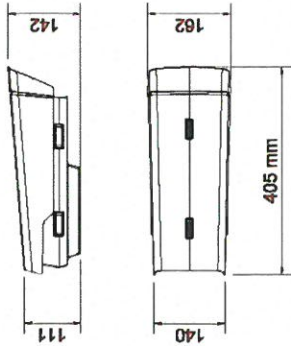

Scale: 1:10@A3

Side View

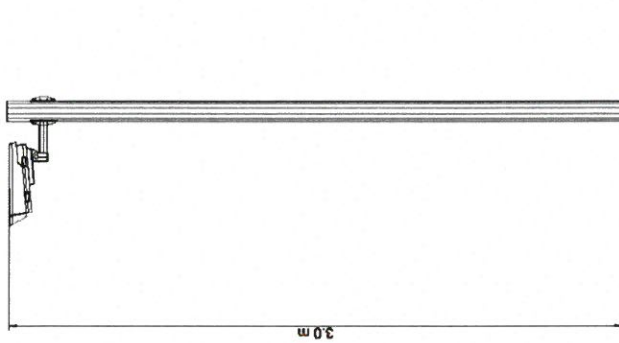

Front View

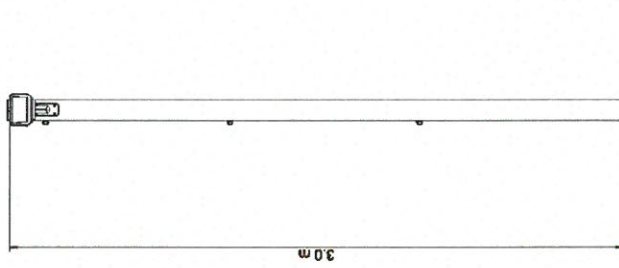

Scale: 1:25@A3

Top View

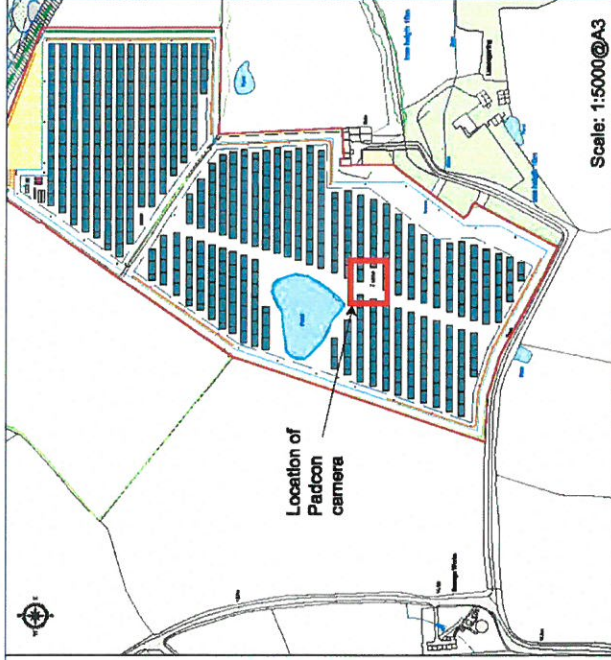
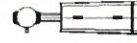

Scale: 1:5000@A3



Reference Padcon Camera - Double Inverter Station



Scale: 1:200@A3

Plan description:  
Bothnwg Solar Farm  
Padcon Camera Elevations

Drawing Reference:  
Bothnwg Solar Farm\_P19\_PFE\_RevA

| Date:      | Editor: | Revision: | Checked: |
|------------|---------|-----------|----------|
| 21/08/2015 | M.L.C.  |           |          |

Date:  
21/08/2015

Scale:  
Various

Coordinates: longitude: -04.5710 latitude: 52.8460

Reference drawings:

Site:  
Bothnwg Solar Farm  
Land south-east of Bothnwg  
Pwllhell,  
Gwynedd  
LL53 8DP



Thorney Well House,  
Thorney Mill Lane, Iwer,  
Buckinghamshire, SL0 9AQ

Tel: +44 (0) 1895 452 640  
Web: www.belectric.co.uk

Variances in design can occur to site conditions. This drawing may not be reproduced or be made available to third persons or competing companies without permissions. The reproduction, distribution and utilization of this document as well as the communication of its contents without explicit authorization is prohibited. Offenders will be held liable and can be fined.



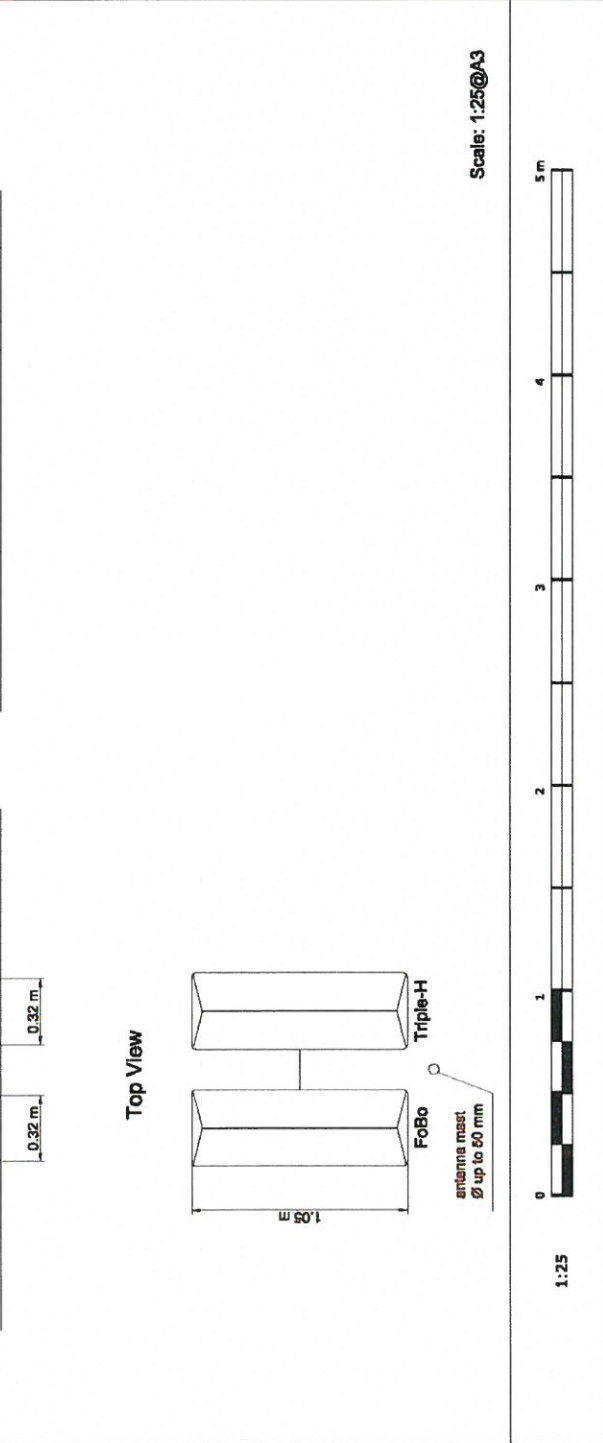
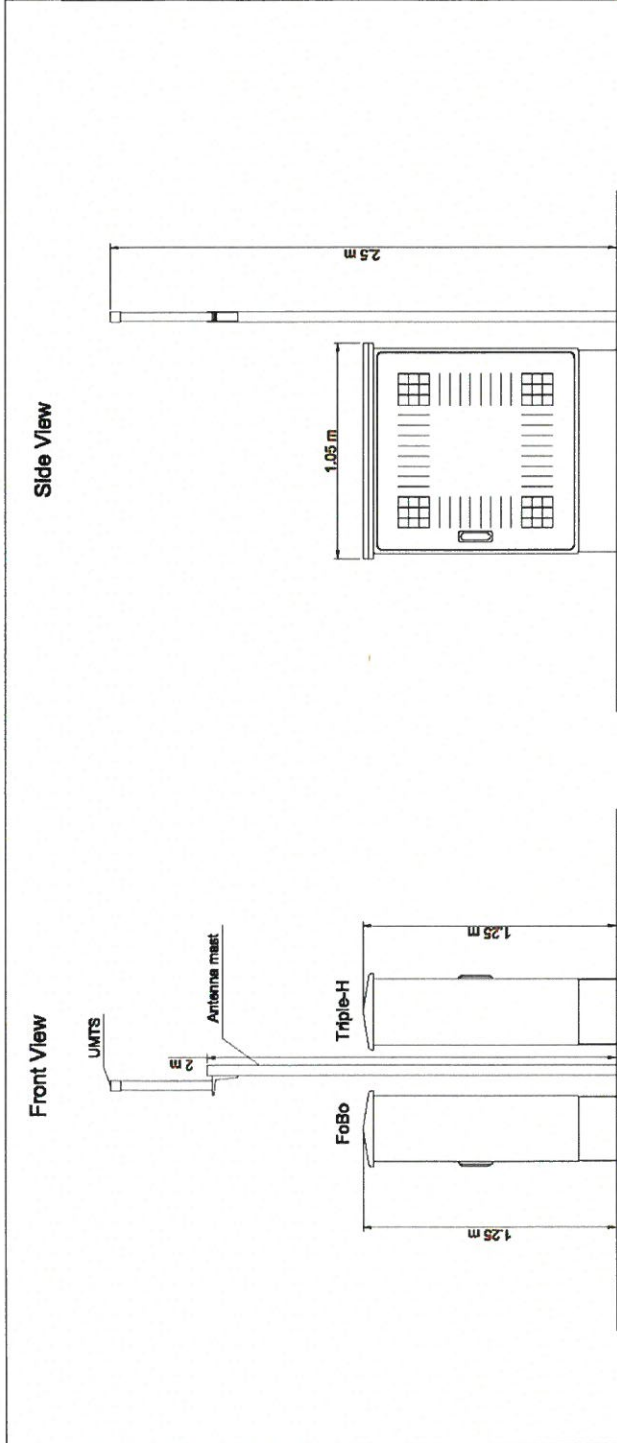
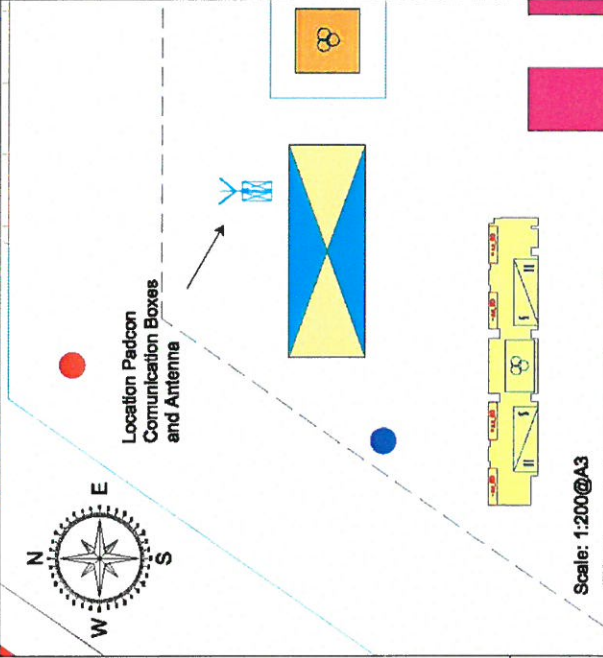
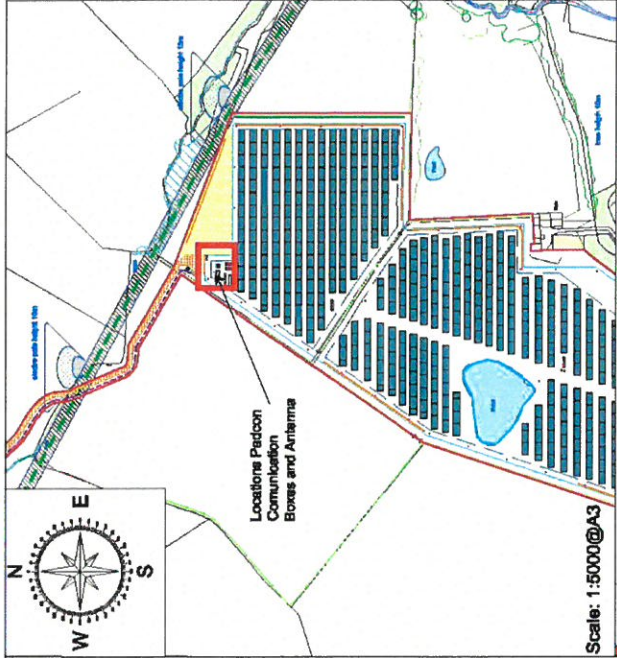

|  |   |
|--|---|
| <b>BELECTRIC®</b><br>Solar Ltd, United Kingdom<br>Thorney Well House,<br>Thorney Mill Lane, Iwer,<br>Buckinghamshire, SLO 8AQ<br>Tel: +44 (0) 1895 452 640<br>Web: www.belectric.co.uk |   |
| <b>Site:</b><br>Botwinnog Solar Farm<br>Land south-east of Botwinnog<br>Pwllheli,<br>Gwynedd<br>LL53 8DP   | <b>Coordinates:</b> longitude: -04.6710 latitude: 62.8460<br><b>Reference drawings:</b> |
| <b>Plan description:</b><br>Botwinnog Solar Farm<br>Peddon Communication Box and Antenna Elevations  | <b>Drawing Reference:</b><br>Botwinnog Solar Farm_P12_PC_NewA                           |
| <b>Date:</b> 21/08/2015<br><b>Editor:</b> M.L.C.   | <b>Date:</b> 21/08/2015<br><b>Scale:</b> various  |
| <b>Revision:</b>   | <b>Checked:</b>   |

Variations in design can occur to site conditions. This drawing may not be reproduced or be made available to third persons or competing companies without permissions. The reproduction, distribution and utilization of this document as well as the communication of its contents without explicit authorization is prohibited. Offenders will be held liable and can be fined.



**Colour of Structure:**  
Moss Green  
(RAL 6005)



Side

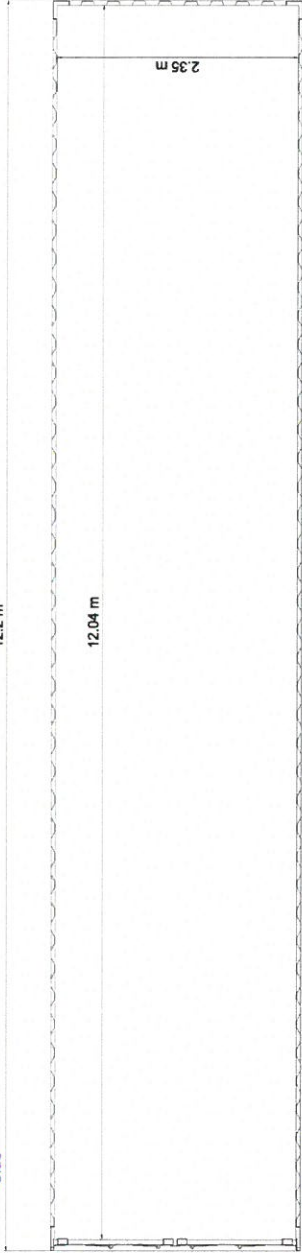

Floor Plan

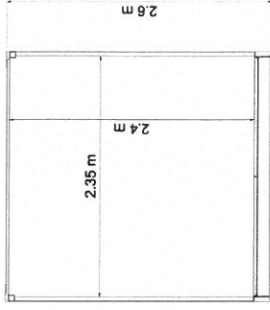

Cross Section

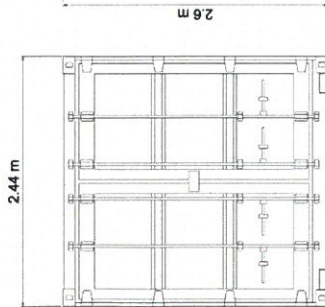

Front

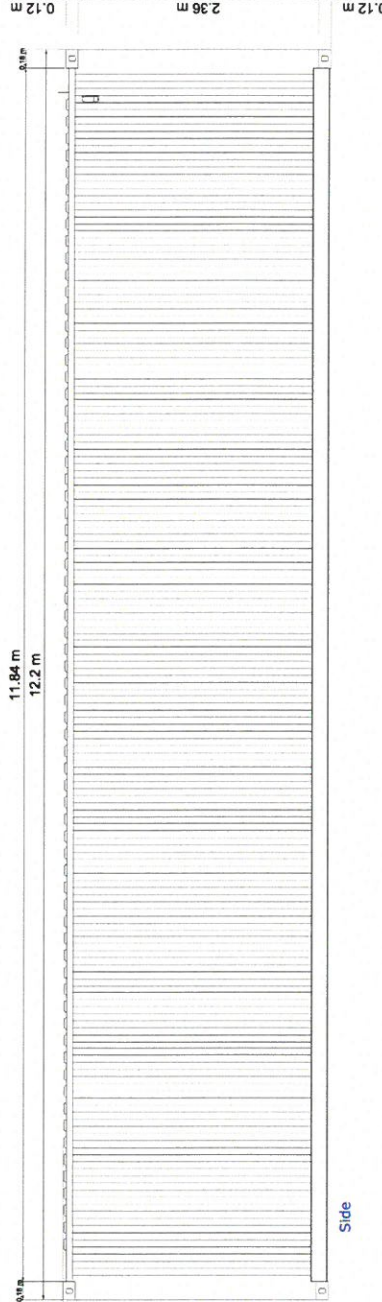

Side



Rear



**Plan description:**  
Bowmng Solar Farm

General Storage Container / Energy Storage Container Elevations

Date: 21/08/2015  
Editor: M.L.C.

Checked:

Drawing Reference:  
Bowmng Solar Farm\_P11\_SC\_RevA

Date: 21/08/2015

Scale: 1:50@A3

Coordinates: longitude: -04.5710 latitude: 52.8460

Reference drawings:

Site:

Bowmng Solar Farm

Land south-east of Bowmng  
Pwllheli,  
Gwynedd

LL53 8DP



Solar Ltd, United Kingdom

Thorney Weir House,  
Thorney Mill Lane, Iwer,  
Buckinghamshire, SL0 9AQ

Tel: +44 (0) 1895 452 640  
Web: www.belectric.co.uk

**Variations in design can occur to site conditions. This drawing may not be reproduced or be made available to third persons or competing companies without permissions. The reproduction, distribution and utilization of this document as well as the communication of its contents without explicit authorization is prohibited. Offenders will be held liable and can be fined.**



### Fence Elevations

### Gate Elevations

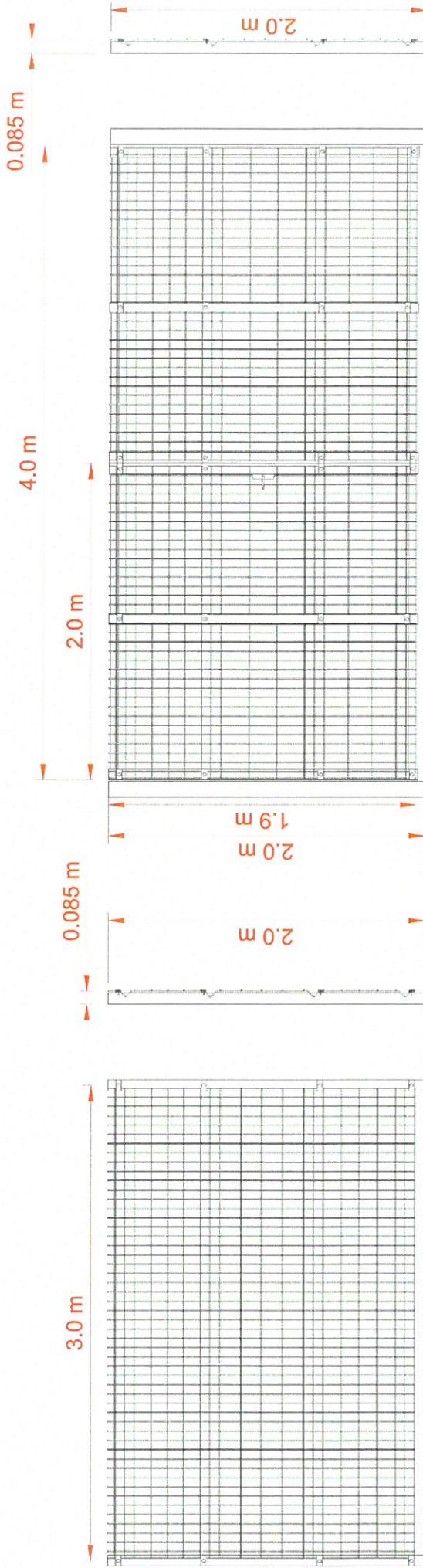

Colour of Structure:  
Moss Green  
(RAL 6005)



|  |                          |  |                 |
|--|--------------------------|--|-----------------|
| <b>Plan description:</b><br>Botwnnog Solar Farm<br>Fence and Gate Elevations                           |                          | <b>Drawing Reference:</b><br>Botwnnog Solar Farm_P110_FGE_RevA |                 |
| <b>Date:</b><br>21/08/2015   | <b>Editor:</b><br>M.L.C. | <b>Revision:</b>   | <b>Checked:</b> |
| <b>Coordinates:</b><br>longitude: -04.5710    latitude: 52.8460  |                          | <b>Reference drawings:</b>                                     |                 |
| <b>Site:</b><br>Botwnnog Solar Farm<br>Land south-east of Botwnnog<br>Pwllheli,<br>Gwynedd<br>LL53 8DP |                          | <b>Scale:</b><br>1:25@A3                                       |                 |
| <b>Coordinates:</b><br>longitude: -04.5710    latitude: 52.8460  |                          | <b>Date:</b><br>21/08/2015                                     |                 |

**BELECTRIC®**  
Solar Ltd, United Kingdom

Thorney Weir House,  
Thorney Mill Lane, Iwer,  
Buckinghamshire, SL0 9AQ

Tel: +44 (0) 1895 452 640  
Web: www.belectric.co.uk

Variations in design can occur to site conditions. This drawing may not be reproduced or be made available to third persons or competing companies without permissions. The reproduction, distribution and utilization of this document as well as the communication of its contents without explicit authorization is prohibited. Offenders will be held liable and can be fined.

Front Elevation

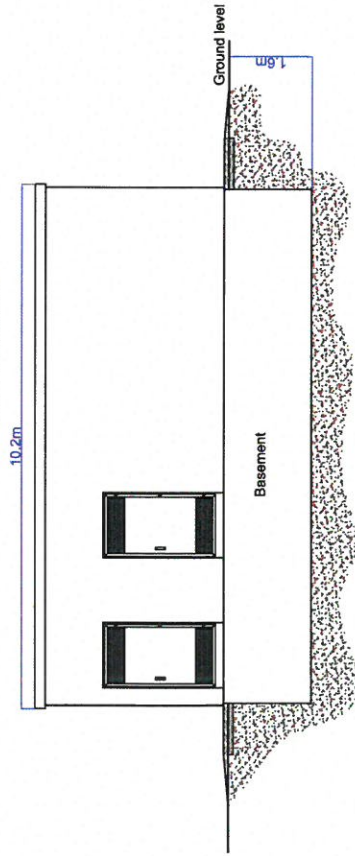

Side Elevation 2

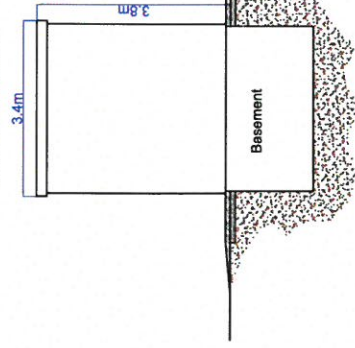

Side Elevation 1

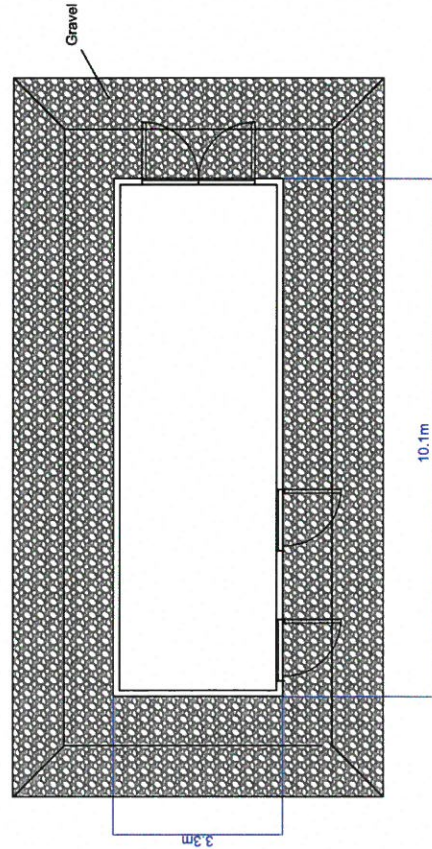
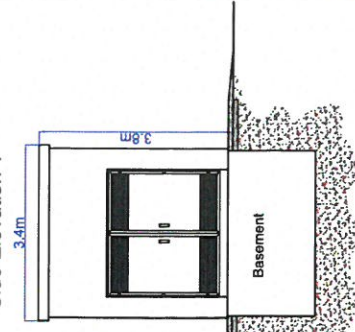

Proposed Floor Plan

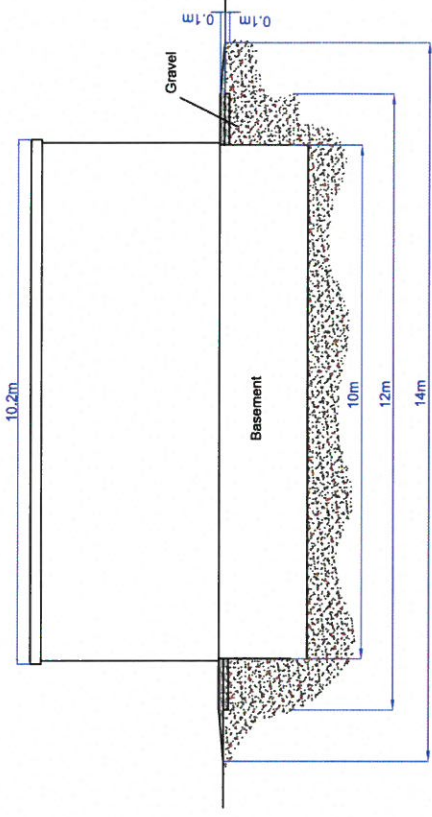

Rear Elevation

Colour of Structure:  
Moss Green  
(RAL 6005)



|  |            |  |          |
|--|------------|--|----------|
| <b>Plan description:</b><br>Botwnnog Solar Farm<br>DNO Transfer Station Elevations   |            | <b>Drawing Reference:</b><br>Botwnnog Solar Farm_P07_TS_RevA   |          |
| Date:  | 21/08/2015 | Editor:  | M.L.C.   |
| Revision:  |            | Checked:   |          |
| Coordinates: longitude: -04.5710 latitude: 52.8460<br>Reference drawings:  |            | Site:<br>Botwnnog Solar Farm<br>Land south-east of Botwnnog<br>Pwllheli,<br>Gwynedd<br>LL53 8DP                                      |          |
| Date:  | 21/08/2015 | Scale:   | 1:100@A3 |
| Variations in design can occur to site conditions. This drawing may not be reproduced or be made available to third persons or competing companies without permissions. The reproduction, distribution and utilization of this document as well as the communication of its contents without explicit authorization is prohibited. Offenders will be held liable and can be fined. |            |  |          |
| <b>OBLECTRIC®</b><br>Solar Ltd, United Kingdom   |            | Thorney Well House,<br>Thorney Mill Lane, Iwer,<br>Buckinghamshire, SLO 9AQ<br>Tel: +44 (0) 1895 452 640<br>Web: www.oblectric.co.uk |          |



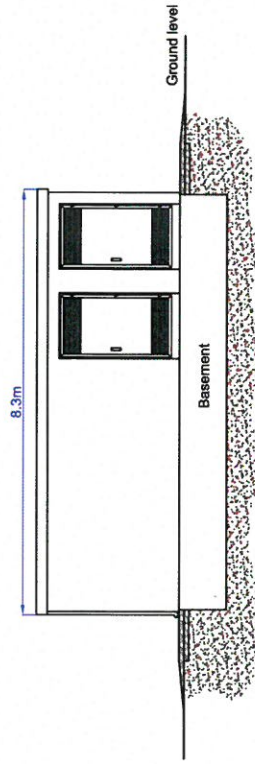

Front Elevation

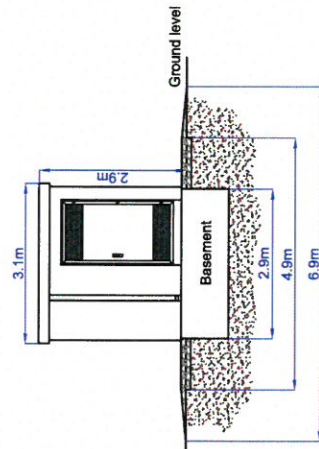

Side Elevation 1

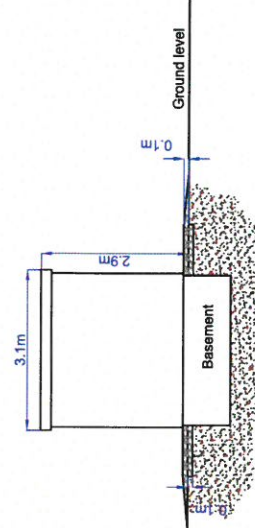

Side Elevation 2

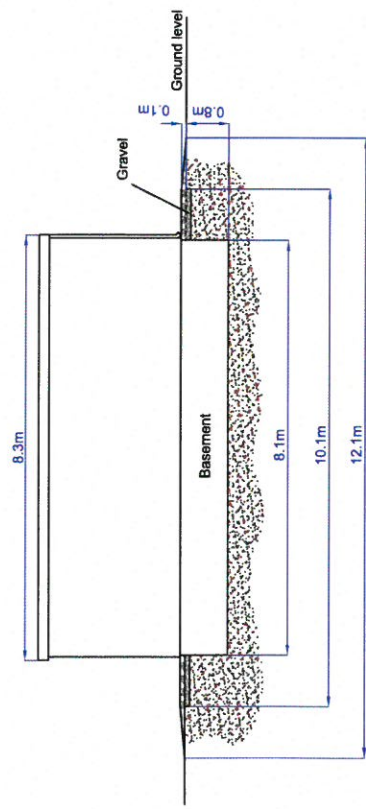

Rear Elevation

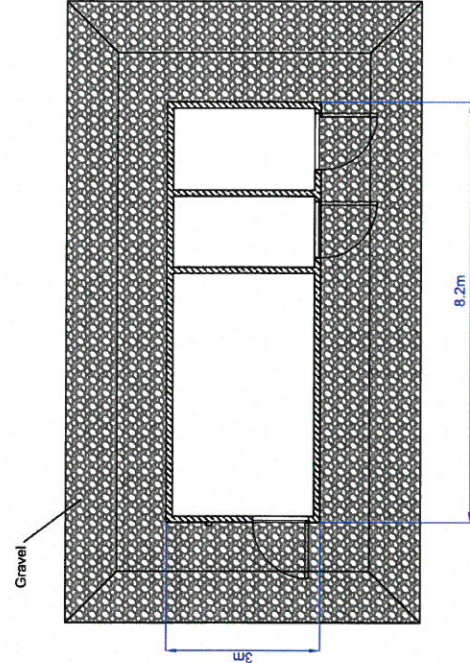

Proposed Floor Plan

Colour of Structure:  
Moss Green  
(RAL 6005)



|  |                          |  |                           |  |   |
|--|--------------------------|--|---------------------------|--|---|
| <b>Plan description:</b><br>Botwnnog Solar Farm<br>Collecting Station Elevations   |                          | <b>Drawing Reference:</b><br>Botwnnog Solar Farm_P06_CS_Rewa |                           | <b>Site:</b><br>Botwnnog Solar Farm                          |   |
| <b>Date:</b><br>21/08/2015   | <b>Editor:</b><br>M.L.C. | <b>Revision:</b>   | <b>Checked:</b>           | <b>Coordinates:</b><br>longitude: -04.5710 latitude: 52.9460 | Land south-east of Botwnnog<br>Pwllheli,<br>Gwynedd<br>LL53 8DP |
| <b>Date:</b><br>21/08/2015   |                          |  | <b>Scale:</b><br>1:100@A3 | <b>Reference drawings:</b>                                   |   |
| Variations in design can occur to site conditions. This drawing may not be reproduced or be made available to third persons or competing companies without permissions. The reproduction, distribution and utilization of this document as well as the communication of its contents without explicit authorization is prohibited. Offenders will be held liable and can be fined. |                          |  |                           |  |   |

**BELECTRIC®**  
Solar Ltd, United Kingdom

Thorney Weir House,  
Thorney Mill Lane, Iwer,  
Buckinghamshire, SL0 9AQ

Tel: +44 (0) 1895 452 640  
Web: www.belectric.co.uk

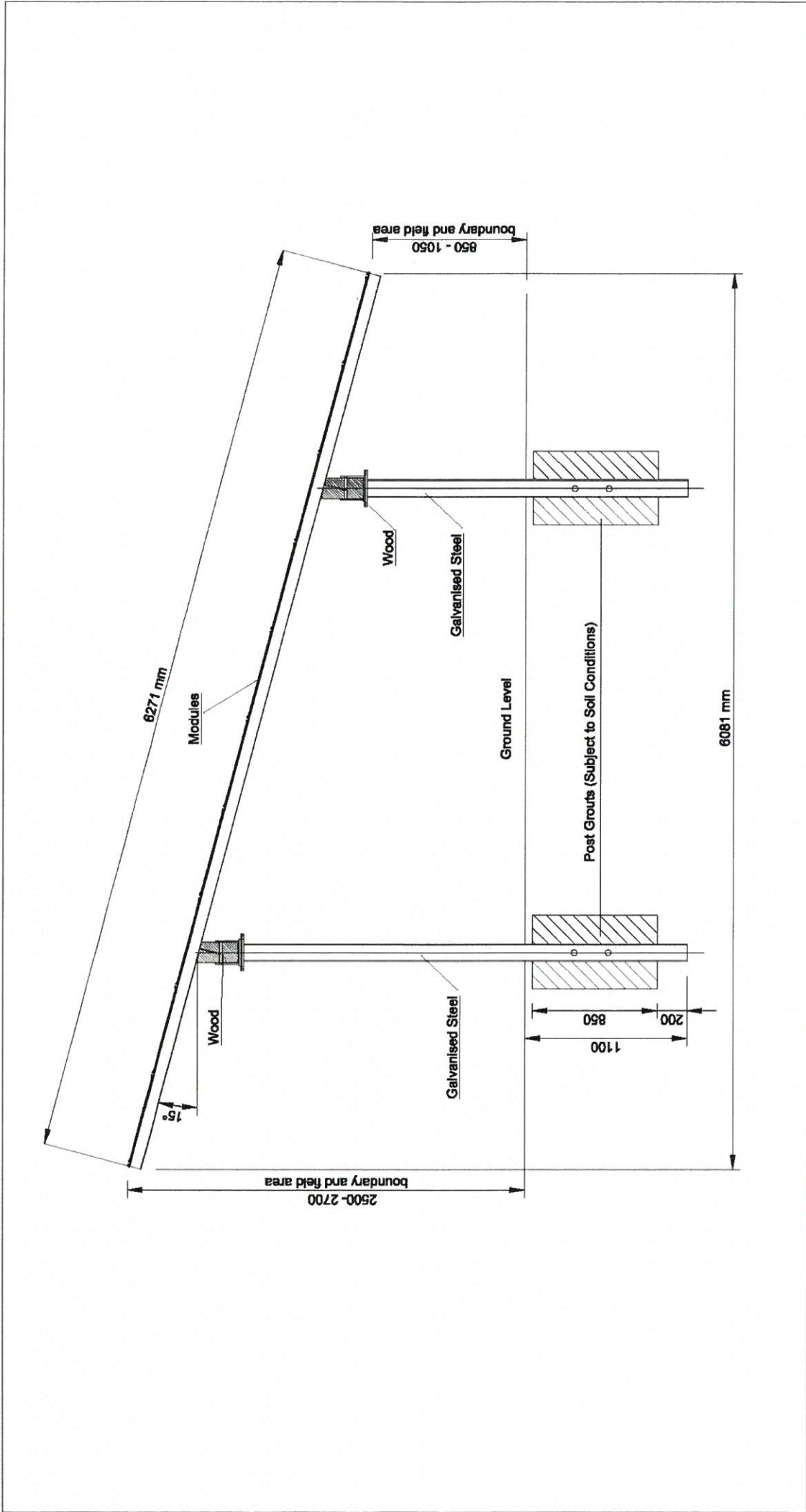

|  |                          |   |                            |
|--|--------------------------|---|----------------------------|
| <b>Plan description:</b><br>Botwnnog Solar Farm<br>Solar Array Cross Section   |                          | <b>Drawing Reference:</b><br>Botwnnog Solar Farm_P02_BA_NewA    |                            |
| <b>Date:</b><br>21/08/2015   | <b>Editor:</b><br>M.L.C. | <b>Revision:</b>  | <b>Checked:</b>            |
| <b>Site:</b><br>Botwnnog Solar Farm<br>Land south-east of Botwnnog<br>Pwllheli,<br>Gwynedd<br>LL53 8DP   |                          | <b>Coordinates:</b><br>longitude: -04.6710    latitude: 52.8460 | <b>Reference drawings:</b> |
| <b>Date:</b><br>21/08/2015   |                          | <b>Scale:</b><br>1:25@A3  |                            |
| Variations in design can occur to site conditions. This drawing may not be reproduced or be made available to third persons or competing companies without permissions. The reproduction, distribution and utilization of this document as well as the communication of its contents without explicit authorization is prohibited. Offenders will be held liable and can be fined. |                          |   |                            |

**BELECTRIC**  
 Solar Ltd, United Kingdom  
 Thorney Well House,  
 Thorney Mill Lane, Iwer,  
 Buddinghamshire, SLO 8AQ  
 Tel: +44 (0) 1895 452 640  
 Web: www.belectric.co.uk



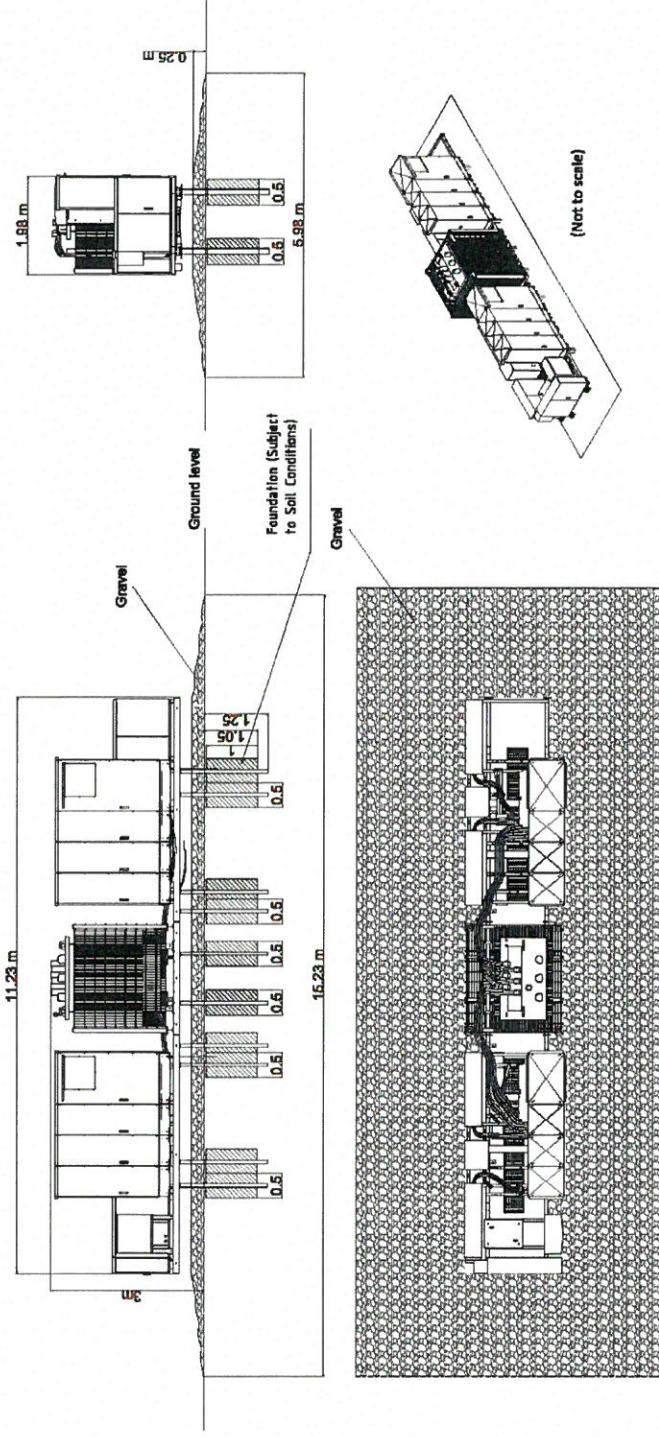

|  |  |   |          |
|--|--|---|----------|
| <b>Plan description:</b><br>Botwnnog Solar Farm<br>Double Inverter Platform Elevations   |  | <b>Drawing Reference:</b><br>Botwnnog Solar Farm_P04_P01_RevA |          |
| Date:  | 21/08/2015   | Editor:   | M.L.C.   |
| Revision:  |  | Checked:  |          |
| Date:  | 21/08/2015   | Scale:  | 1:100@A3 |
| Coordinates:   | Longitude: -04.6710  | Latitude:   | 52.8460  |
| Reference drawings:  |  |   |          |
| Site:  | Botwnnog Solar Farm<br>Land south-east of Botwnnog<br>Pwllheli,<br>Gwynedd<br>LL53 8DP |   |          |
|  |  |   |          |
| Thorney Weir House,<br>Thorney Mill Lane, Iwer,<br>Buckinghamshire, SL0 8AQ<br>Tel: +44 (0) 1895 452 840<br>Web: www.belectric.co.uk |  |   |          |

Variances in design can occur to site conditions. This drawing may not be reproduced or be made available to third persons or competing companies without permissions. The reproduction, distribution and utilization of this document as well as the communication of its contents without explicit authorization is prohibited. Offenders will be held liable and can be fined.



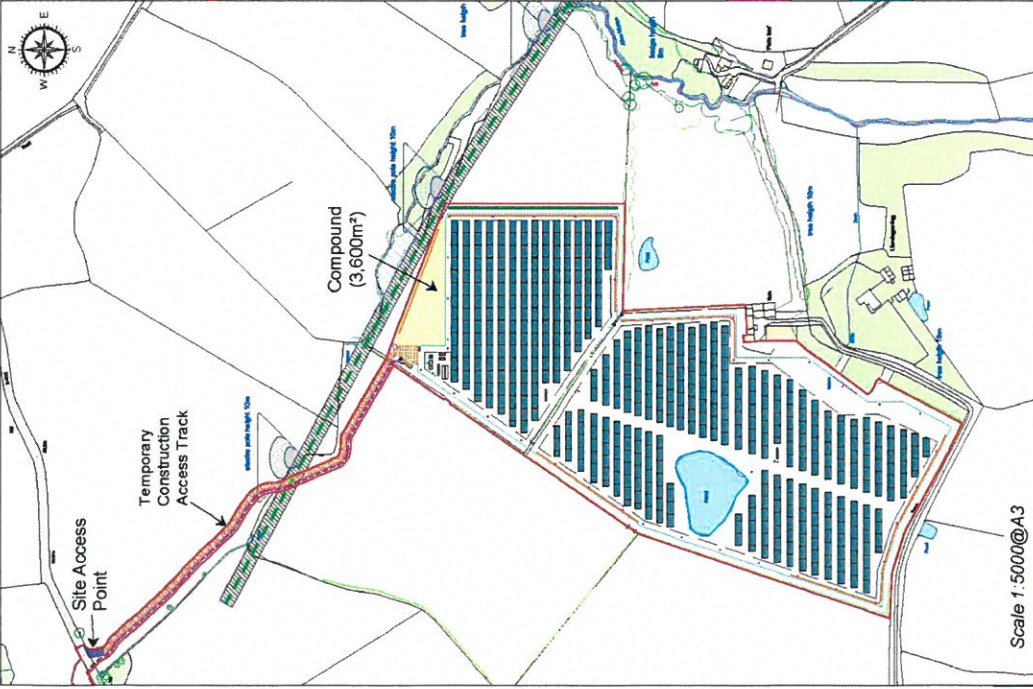

Scale 1:5000@A3

- Site Boundary
- ▨ Temporary Construction Access Track
- Temporary Construction Compound

Plan description:  
 Botwnnog Solar Farm  
 Temporary Construction Compound Layout Plan

| Date:      | Editor: | Revision: | Checked: |
|------------|---------|-----------|----------|
| 21/08/2015 | M.L.C.  |           |          |
| 20/11/2015 | M.L.C.  |           |          |

Drawing Reference:  
 Botwnnog Solar Farm\_P03\_OC\_RevB

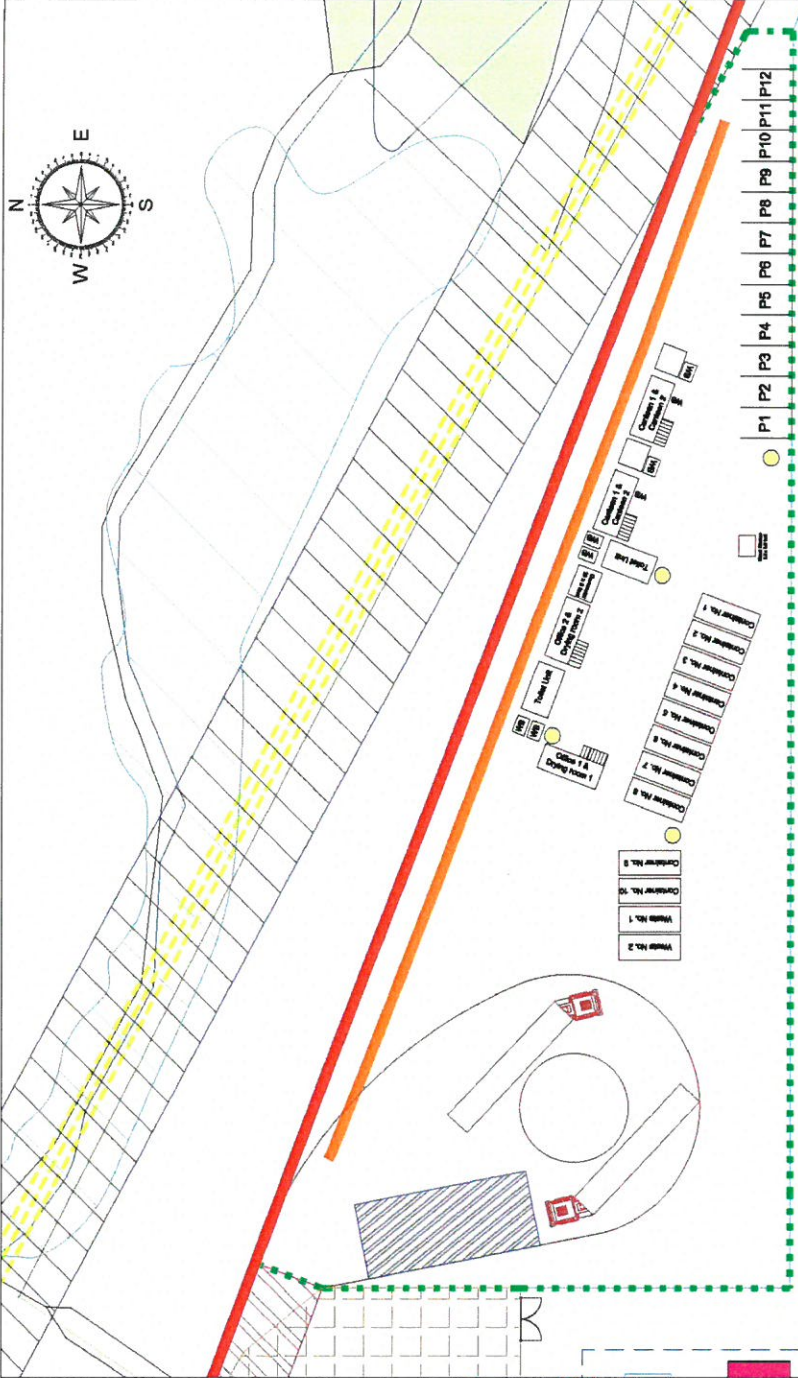

Scale 1:500@A3

- Site Boundary
- ▨ Wheel Washing Area
- Mobile Security Lighting Towers (Hydraulically adjustable in height)
- Employee Car Park Spaces
- Construction site facilities
- Box Trakpanel temporary laydown area
- Waste / recycling
- Water Bowser
- Effluent Tank

Coordinates: longitude: -04.5710 latitude: 52.8460

Reference drawings:

Date: 20/11/2015  
 Scale: Various

Site:  
 Botwnnog Solar Farm  
 Land south-east of Botwnnog  
 Pwllhell  
 Gwynedd  
 LL53 8DP



Thorney Weir House,  
 Thorney Mill Lane, Iwer,  
 Buckinghamshire, SLO 9AQ  
 Tel: +44 (0) 1895 452 640  
 Web: www.belectric.co.uk

Variances in design can occur to site conditions. This drawing may not be reproduced or be made available to third persons or competing companies without permissions. The reproduction, distribution and utilization of this document as well as the communication of its contents without explicit authorization is prohibited. Offenders will be held liable and can be fined.



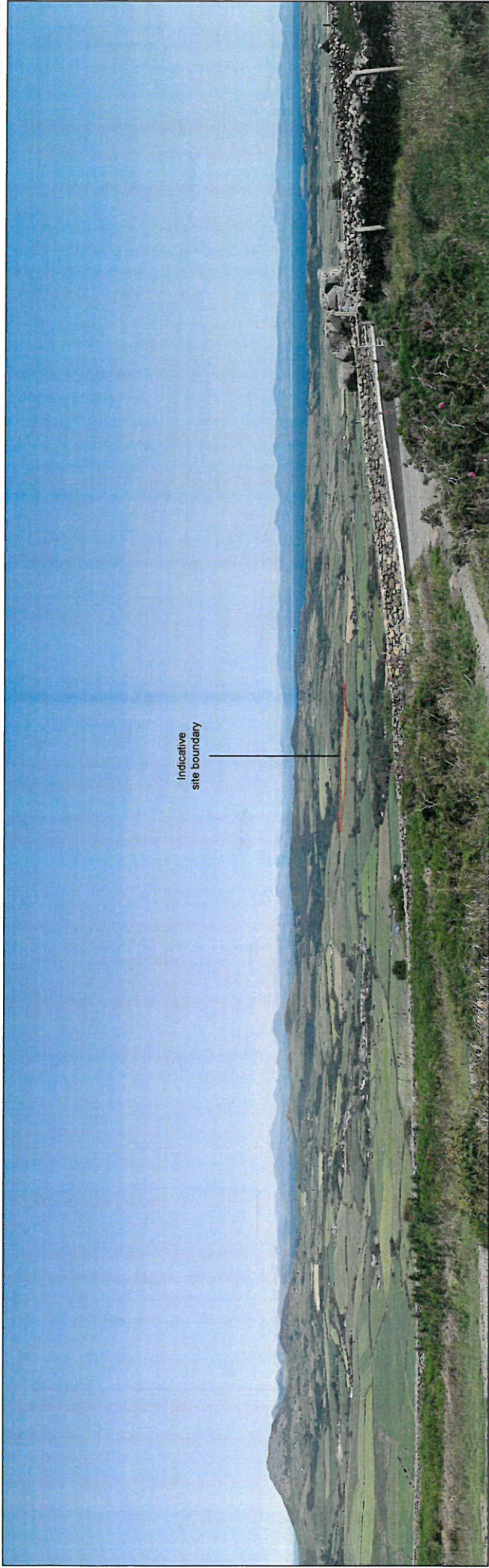

Indicative site boundary

| COMPONENTS OF EXISTING VIEW  |   | COMPONENTS OF PROPOSED VIEW:  |   |
|--|---|---|---|
| CLASSIFICATION OF RECEPTOR   | DESCRIPTION OF VIEW   | DURING CONSTRUCTION   | FOLLOWING COMPLETION OF WORKS   |
| <p><b>Angle of View:</b> 90°</p> <p><b>View Looking from:</b> Car park off unnamed road on east slope of Mynydd Rhiw.</p> <p><b>Classification of Receptor:</b> PRoW/Open Access/Highway</p> <p><b>Distance from Scheme (nearest point):</b> 3km</p> <p><b>Elevation:</b> 231m</p> <p><b>Sensitivity:</b> High (PRoW/Open Access) Medium (Highway)</p> | <p><b>Foreground:</b><br/>Scrub surrounding car park across view with unnamed road and adjacent dy stone wall beyond.</p> <p><b>Middle Distance:</b><br/>Majority of view screened by falling topography of Mynydd Rhiw, with agricultural fields across view beyond, divided by fencing, hedgerows, trees and woodland blocks.</p> <p><b>Far Distance:</b><br/>Agricultural fields across view, divided by fencing, hedgerows, trees and woodland blocks. Site is partially visible centre of view as fields in front of woodland block and woodland along Afon Horon. Botwnnog visible left of view, with Garn Fadryn visible beyond, far left of view. Cardigan Bay visible across right of view. Mountains within Snowdonia National Park visible across the horizon.</p> | <p><b>As existing with:</b><br/>distant views of construction of solar arrays, fencing and CCTV poles and temporary construction compound seen against woodland, and of vehicles on access track centre of view, partially screened by intervening topography and vegetation.</p> | <p><b>As existing with:</b><br/>distant views of solar arrays, fencing, CCTV poles, PCUs, transfer station and collecting station seen against woodland, and of vehicles on access track centre of view, partially screened by intervening topography and vegetation.</p> |
|  | <b>MAGNITUDE OF IMPACT</b>  | Negligible-Low  | Negligible-Low  |
|  | <b>SIGNIFICANCE OF IMPACT</b>   | Slight Adverse (PRoW/Open Access)<br>Negligible-Slight Adverse (Highway)  | Slight Adverse (PRoW/Open Access)<br>Negligible-Slight Adverse (Highway)  |

**LOCATION OF PHOTOVIEW**

© Crown Copyright and database rights 2015  
Ordnance Survey 0100031673

**GRID REF**

E: 223715m  
N: 329825m

1717 Park Street, Cardiff, CF10 1NF, Wales, UK



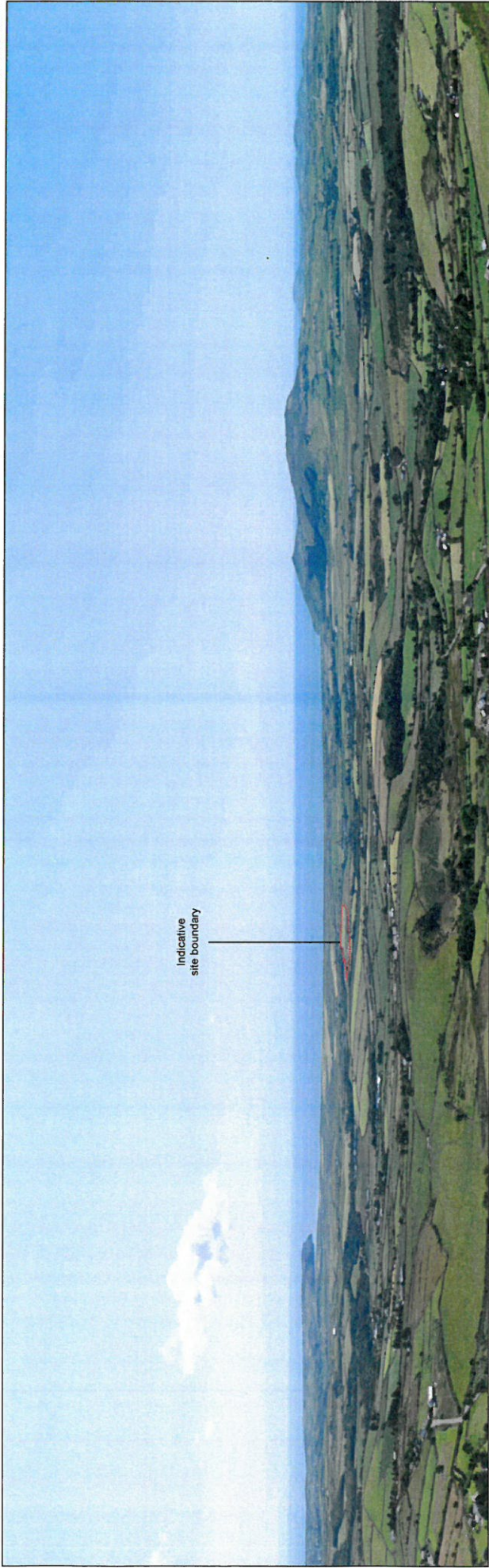

| COMPONENTS OF PROPOSED VIEW:  |   | GRID REF   |  |
|---|---|--|--|
| <b>CLASSIFICATION OF RECEPTOR</b>   | <b>COMPONENTS OF EXISTING VIEW</b>  | <b>DURING CONSTRUCTION</b>   | <b>FOLLOWING COMPLETION OF WORKS</b>   |
| <p><b>Angle of View:</b> 90°</p> <p><b>View Looking from:</b> Footpath on southern slope of Garm Fadryn</p> <p><b>Classification of Receptor:</b> Open Access</p> <p><b>Distance from Scheme (nearest point):</b> 4.1km</p> <p><b>Elevation:</b> 288m</p> <p><b>Sensitivity:</b> High</p> | <p><b>DESCRIPTION OF VIEW</b></p> <p><b>Foreground:</b><br/>View screened by falling topography of Garm Fadryn.</p> <p><b>Middle Distance:</b><br/>Agricultural fields across view, divided by fencing, hedgerows, trees and woodland blocks. Individual farmsteads scattered across view. Unnamed roads extending south of Garmfadryn village visible far left and centre-right of view.</p> <p><b>Far Distance:</b><br/>Agricultural fields across view, divided by fencing, hedgerows, trees and woodland blocks. Site is partially visible centre-left of view within fields in front of and to the right of woodland block. Cardigan Bay visible across horizon, with Mynydd Rhiw visible right of view.</p> | <p><b>As existing with:</b><br/>distant views of construction of solar arrays, fencing and CCTV poles and temporary construction compound in front of and to the right of woodland block and of vehicles on access track centre-left of view, partially screened by intervening topography and vegetation.</p> | <p><b>As existing with:</b><br/>distant views of solar arrays, fencing, CCTV poles, PCUS, transfer station and collecting station in front of and to the right of woodland block and of vehicles on access track centre-left of view, partially screened by intervening topography and vegetation.</p> |
|   | <b>SIGNIFICANCE OF IMPACT</b>   | <b>OF IMPACT</b>   |  |
|   | Negligible-Low  | Negligible   | Negligible Adverse   |
|   | Slight Adverse  |  |  |

**LOCATION OF PHOTOVIEW**

© Crown Copyright and database rights 2015  
Ordnance Survey, 0100031673

**GRID REF**

E: 228045m  
N: 334873m

wardell armstrong

E:\Projects\Botwnnog Solar Farm\Design\MapDocs\0100031673\PhotoView.dwg